

DISCLOSURE PLAN

This plan shows details of proposed Lots 290 – 292 on proposal plan G2286 Revision E dated 17 May 2004 which accompanied a subdivision application (approved by Gladstone City Council on 12-06-2004 – subject to conditions)

The engineering drawings were subsequently approved in June, 2005.

POINT OF COMMENCEMENT
 Connection from most Northerly corner of Lot 303 on SP148529 to the Northerly most corner of proposed Lot 292 is:
 coincident with the point of commencement

CONTOUR INFORMATION
 Design contours shown hereon are on AHD and at 0.5m intervals.

LEGEND

	O/H Elect. Lines (Existing)
	Contour Line (Index)
	Contour Line (Inter.)
	Proposed New Sewer Line

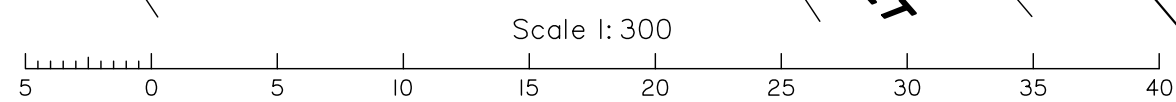
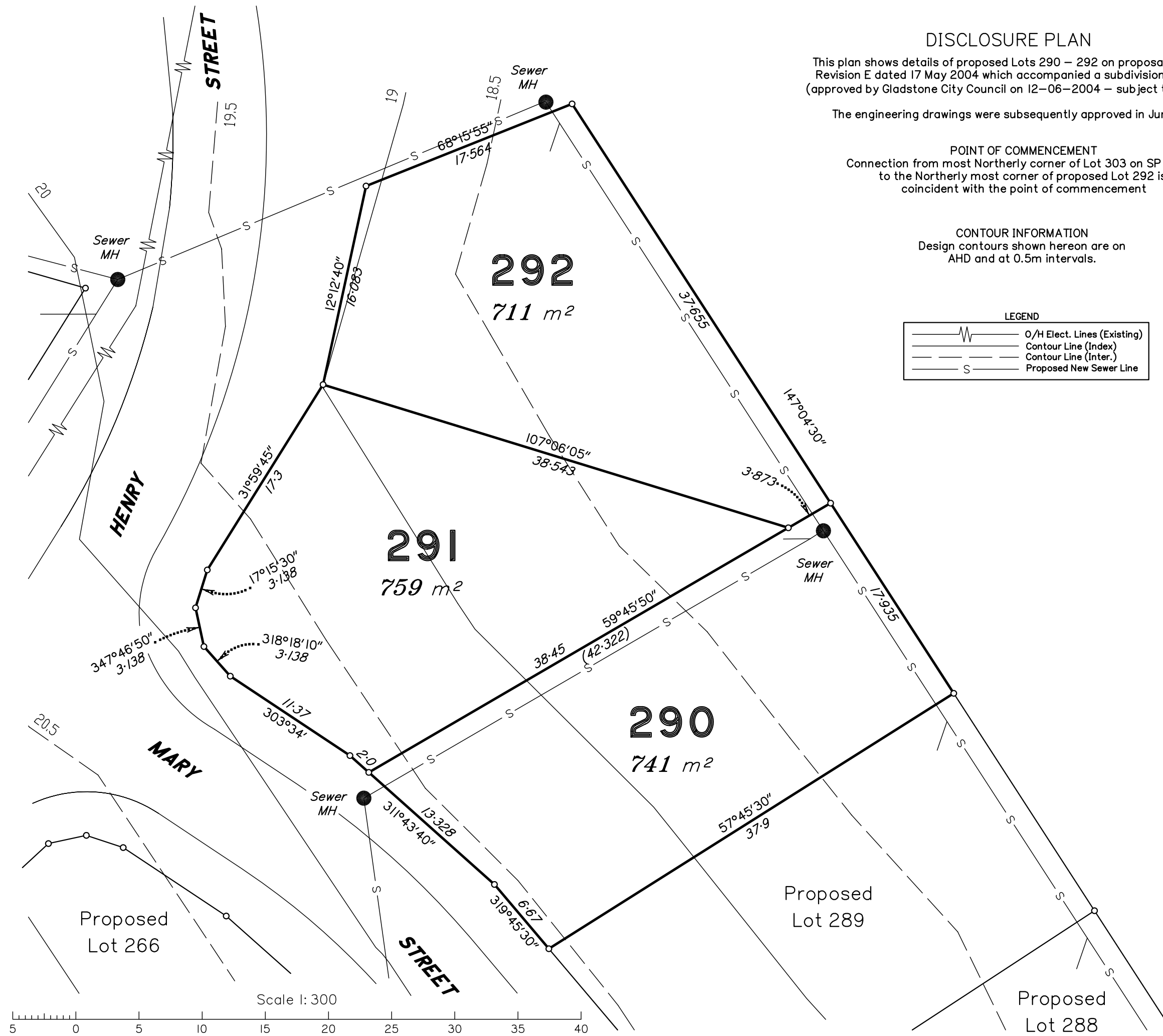

SURVEYOR		
PRINCIPAL		
PROJECT DISCLOSURE PLAN PROPOSED LOTS 290 – 292 EMMADALE PARK GLADSTONE		
REAL PROPERTY DESCRIPTION Lot No : Lots 302 & 303 Plan : SP148529 Orig. Por: Lot 117 on CTN2093 Parish : AUCKLAND County : Clinton L.A. : GLADSTONE C.C. Zone : RESIDENTIAL		
REVISIONS	DATE	INITIALS
SOURCE DATA	FILE REF: 5959	
DRAFTING SURVEY	VERSION:	
	DATA DISK:	
	DATE:	
DRAFTING SURVEY	FILE REF: 5959-290-292-D1	
	DATA DISK:	
	DATE:	
SURVEYED:		
DRAWN: MCS DRAFTING		
QUALITY CH'D:		
DATE: 24-06-2005		
DATUM	HORIZONTAL :-	
	CO-ORD ORIGIN :-	
SCALE 1:300		
5 0 5 10		
AUTHORISED BY DATE		
DIRECTOR & LICENSED SURVEYOR		
JOB NO. 5959-290-292-D1		